

PRODUCTION & DOWNHOLE | SUCKER ROD PRODUCTS

# CONELOK™ XF SHEAR COUPLING



## Features

- Proven Superb Fatigue Resistance in Challenging Wells
- Straight-Pull Activation (Tension)
- Box x Box API111B Connections
- Optional Urethane Coating for Wear Resistance
- US Patent 9,604,493, other international Patents Pending.



## THE CONELOK™ ADVANTAGE

The patent-pending ConeLok™ XF shear coupling from Hawkeye Industries Inc. represents a quantum leap forward in increasing MTBF events in challenging completions. Suitable for use in progressive cavity pump and reciprocating applications, the ConeLok™ XF lowers operating costs, improves uptime and provides peace of mind to operators and bean counters alike. The superior, proven performance of the ConeLok™ XF Shear Coupling is a result of three key design features:

- ConeLok™ Precision Connection
- Large Diameter Spud
- Short, radially offset Shear Pin

### ConeLok™ Precision Connection

- Innovative torsion bearing geometry eliminates cumbersome polygon keys.
- Interference fit supports torsional loading on entire surface of connection, not just the corners as in a legacy shear coupling.
- Lessens diametrical stress risers improving fatigue resistance
- Allows use of larger diameter spud

### Large Diameter Spud

- Spud Diameter not limited by minor diameter of polygon key as in legacy couplings.
- Increased diameter increases bulk strength of connection, and also improves fatigue resistance
- Large Diameter spud is two times stronger than legacy coupling spud in tension, and 2.7 times as strong in bending.

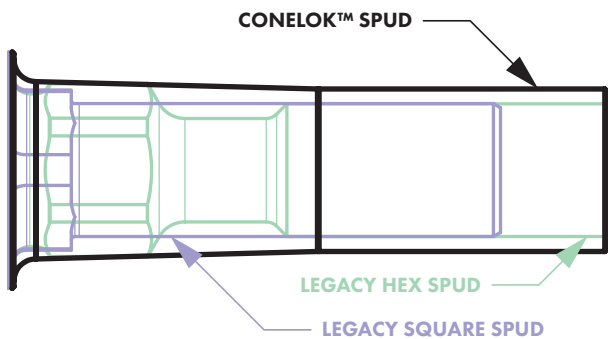

### Short Shear Pins

- Short shear pins reduce effect of stress risers associated with through holes, increasing bulk strength and improving fatigue life.
- Eliminates non-reversible bending in shear pins leading to pin fatigue in reciprocating applications.

## DIMENSIONS

Dimension		7/8" SH Box x Box	1" SH Box x Box
OD	Outside Diameter	1.63 in	2.0 in
L	Overall Length	10.8 in	11.6 in
CD	Coating Diameter	1.9 in	2.3 in
CL	Coating Length	4.3 in	4.3 in
CO	Coating offset	1.8 in	1.8 in
W	Weight	4.8 lb	8.1 lb

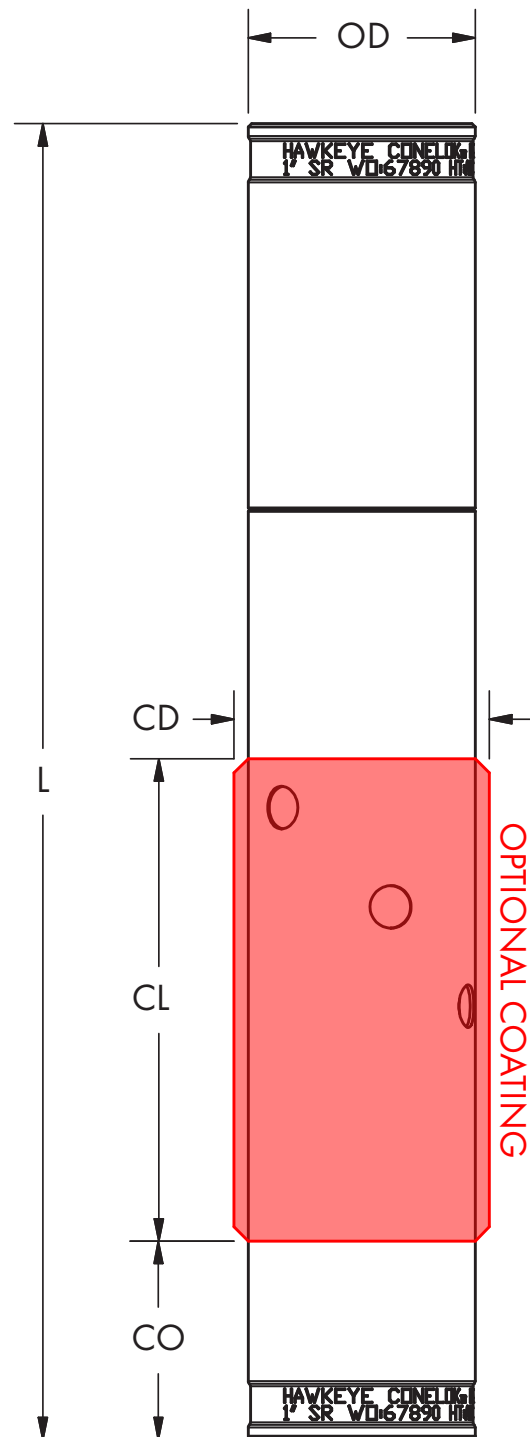

## ACTIVATION LOADS

Activation Load	Pin Colour	
30,000 lbf	Blue	
35,000 lbf	Green	
40,000 lbf	Yellow	†
45,000 lbf	Red	
52,500 lbf	White	†

† items stocked for immediate delivery.

Activation Loads above are for isolated tensile loading, and are accurate to within +5%, -0%.

## OPTIONAL COATING

Upon customer request, an optional Shore A 95 Urethane coating can be applied to the ConeLok XF Shear coupling by a third-party vendor.

## SERVICING

Due to the nature of the operational life of a shear coupling, it is not recommended that ConeLok™ XF Shear Couplings be refurbished or serviced following use. There are no user-replacable parts available at this time.

## APPLICATION RECOMMENDATIONS

The following recommendations will maximize the performance and fatigue life of the ConeLok™ XF and XFC Coupling.

Recommendation	PC Pump	Reciprocating
Operating Tension (% of activation load)	70 - 80 %	50 - 70%
Operating Torque	3,400 ft-lb (1") 2,780 ft-lb (7/8")	
Placement	At least one rod length from pump	

For operation at higher temperatures, apply the following derating factors to the tension and torque ratings above.

Temperature Range	Derating factor
0 - 100 °C	1.0
101 - 150 °C	0.98
151 - 200 °C	0.97
201 - 260 °C	0.96
261 - 315 °C	0.94
316 - 375 °C	0.92
376 - 425 °C	0.9

## FISHING DIMENSIONS

Dimension	7/8" SH	1" SH
OD Outside Diameter	1.63 in	2.0 in
SL Spud Length	2.3 in	2.4 in
SD Spud Diameter	1.2 in	1.4 in

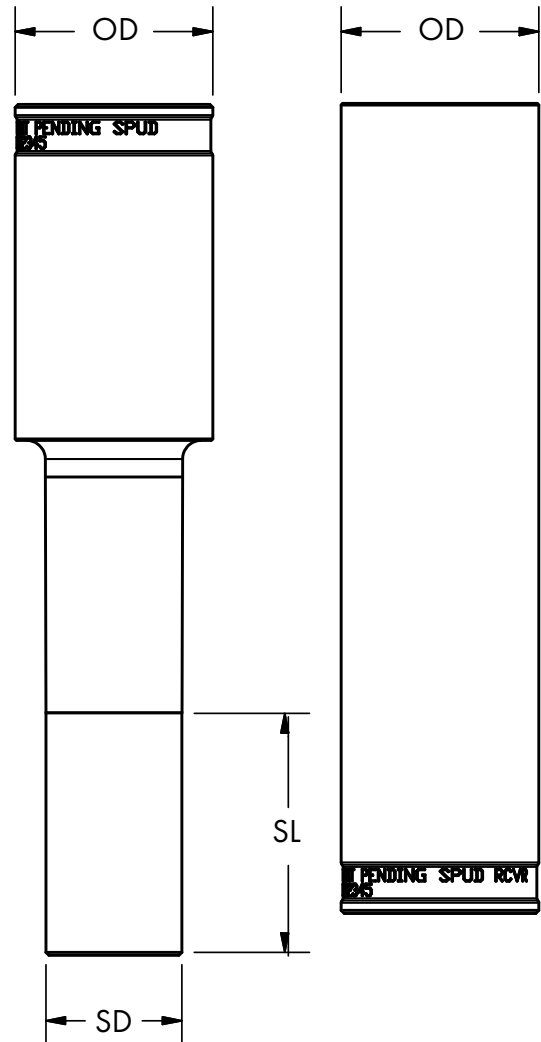

## INSTALLATION ORIENTATION

Coupling performance is not affected by installation orientation. However, for ease of fishing of an activated coupling, each end of the ConeLok™ XF Coupling is stamped with its component name (SPUD or SPUD RCVR) corresponding to the components above.

## MATERIALS OF CONSTRUCTION

The body of the ConeLok™ XF shear couplings is made from AISI 4340 HTSR Steel, and the shear pins are a proprietary steel alloy.





## RELATED PRODUCTS

The ConeLok™ XF shear coupling is part of Hawkeye Industries Inc.'s line of production and downhole equipment, which includes:

- Tubing Centralizers
- Tubing Shears
- Tubing Drains
- Torque Anchors
- Pump-out Plugs,
- Seating Cups
- Polished-Rod Bullets

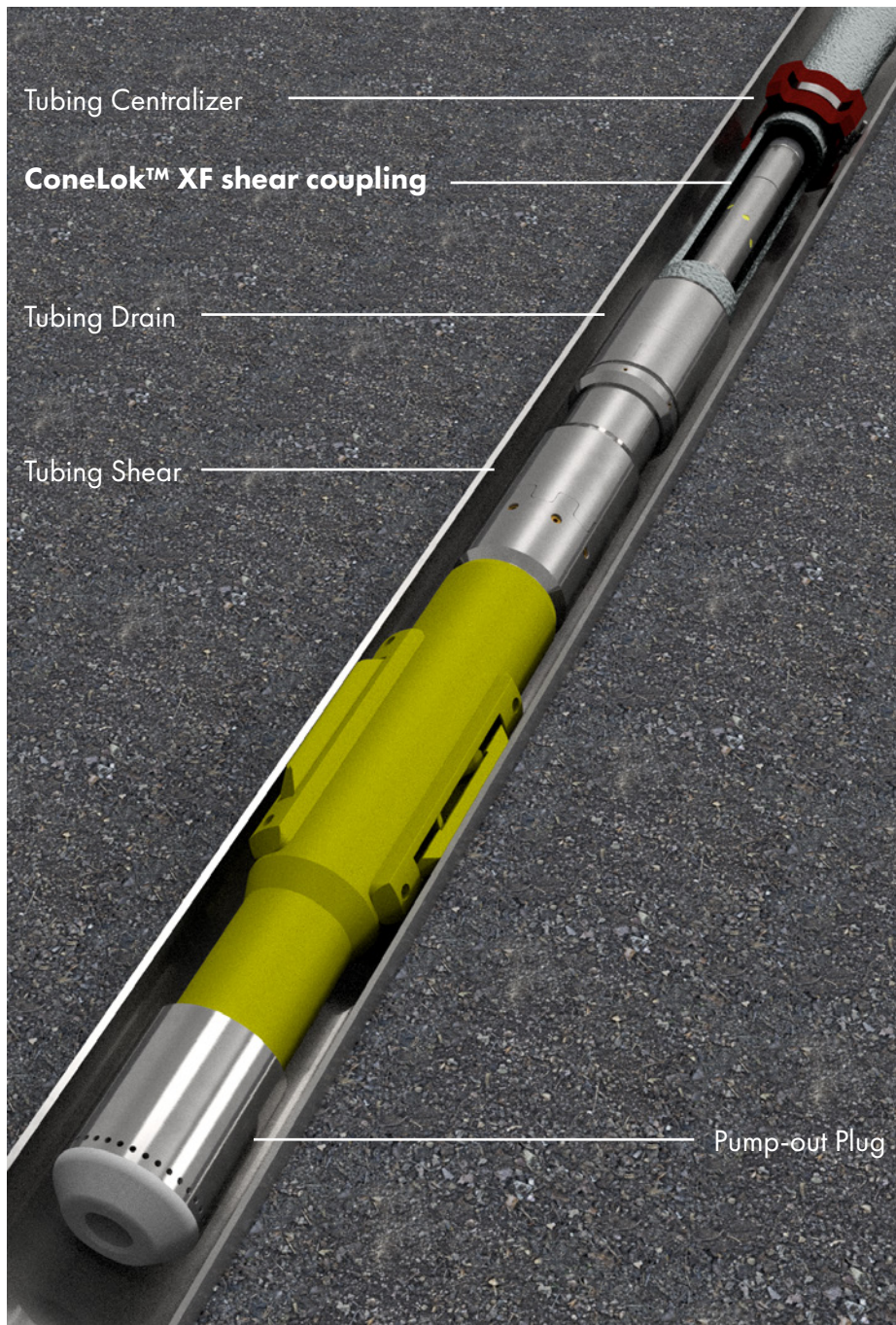

## ORDERING INFORMATION

### ConeLok™ XF Shear Coupling

1. Specify "ConeLok XF Shear Coupling"
2. Specify Connection Size
3. Specify Activation Load

### ConeLok™ XFC Coated Shear Coupling

1. Specify "ConeLok XFC Coated Shear Coupling"
2. Specify Connection Size
3. Specify Activation Load

## PACKAGING

ConeLok™ XF shear couplings shipped individually or in bulk have thread protectors installed on both sucker rod connections.

Consult your sales rep for order-specific shipping or packaging instructions.